

# Morse Taper sizes

Different Morse tapers have easily distinguished sizes.

Measure at the big end (ie, the open hole), in inches:

- #0 is 0.356
- #1 is 0.475
- #2 is 0.700
- #3 is 0.938
- #4 is 1.231,
- #5 is 1.748
- #6 is 2.494
- #7 is 3.270

**Principal dimensions of Morse Taper Shank in accordance with BS1660, 1972 / ISO 296/DIN 228**

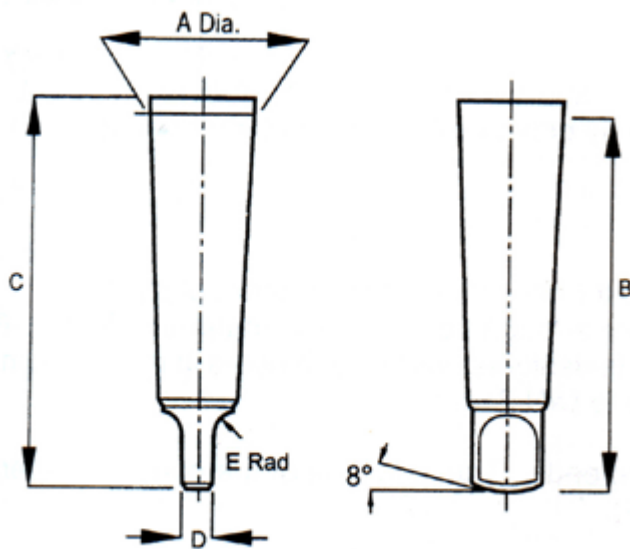

| MORSE<br>TAPER<br>No. | A<br>mm | B<br>mm | C<br>mm | D<br>mm | E<br>mm | TAPER<br>per mm<br>on dia. |
|-----------------------|---------|---------|---------|---------|---------|----------------------------|
| 1                     | 12.065  | 62.0    | 65.5    | 5.2     | 5       | 0.04988                    |
| 2                     | 17.780  | 75.0    | 80.0    | 6.3     | 6       | 0.04995                    |
| 3                     | 23.825  | 94.0    | 99.0    | 7.9     | 7       | 0.05020                    |
| 4                     | 31.267  | 117.5   | 124.0   | 11.9    | 8       | 0.05194                    |
| 5                     | 44.399  | 149.5   | 156.0   | 15.9    | 10      | 0.05263                    |